

Davidson Executive Office Suites



630 Davidson Gateway Dr.

Davidson NC 28036

Executive Office Suite 150

Offices

150-A

150-B

150-C Available - 198sf *\$810

150-D Available - 115sf *\$525

150-E

150-F

150-G

150-H

150-I

* All lease rates based on a 1-year lease
agreement

Contact Information:

Alan Steighner

704-506-1376

alan@nichx.com

THE SPACE

Location	630 Davidson Gateway Dr. Suite 150
County	Mecklenburg
Total Square Feet	1702
Rent Per SF (Annual)	Per unit size
Lease Type	FSG
Floor	1

The Space Highlights

- ☐ 9 Keyman Offices
- ☐ Office Sizes Between 91SF & ~200SF
- ☐ Keycode Entry
- ☐ Ample Parking
- ☐ Quick Accessibility to I-77 via Exit 30
- ☐ Surrounded by Gateway Shops & Restaurants
- ☐ 5 Minutes Drive to Historic Downtown Davidson
- ☐ 5 Minutes Davidson College
- ☐ 24/7 Access to your office
- ☐ Wifi, cloud base storage and VPN available upon request



Demographics



POPULATION

1 MILE	3 MILE	5 MILE
5,941	37,517	87,470



AVERAGE HOUSEHOLD INCOME

1 MILE	3 MILE	5 MILE
\$111,298	\$123,986	\$125,222



NUMBER OF HOUSEHOLDS

1 MILE	3 MILE	5 MILE
2,263	13,906	32,301

NEIGHBORING PROPERTIES

NORTH	Homewood Suites, Subway, Sabi Asian Bistro,
SOUTH	Hello Sailor Restaurant
EAST	Sabor Latin Street Grill , Starbucks, Clean Juice, Kindred, Summit
WEST	North Harbor Club Restaurant

TENANT INFORMATION

LEASE TYPE	FSG
------------	-----

Interior



DAVIDSON OFFICE SUITES

Floorplan

Davidson Gateway Drive

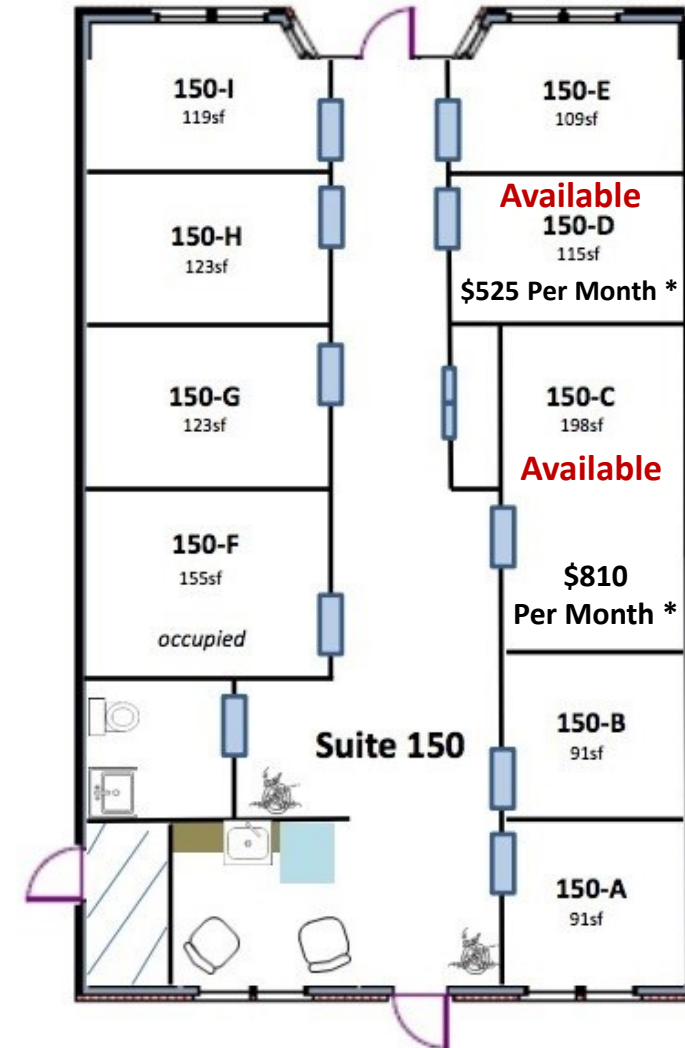

Parking Lot

* All lease rates based on a 1-year lease agreement

Exterior Photo (Rear)**Exterior Photo (Front)****Demographics****1 MILE RADIUS**

41.0

Median Age

2.14

Average
Household Size**3 MILE RADIUS**

39.6

Median Age

2.36

Average
Household Size**5 MILE RADIUS**

39.8

Median Age

2.47

Average
Household Size



CONFIDENTIALITY AND DISCLAIMER

The information contained in the following offering memorandum is proprietary and strictly confidential. It is intended to be reviewed only by the party receiving it from Maxim Investment LLC and it should not be made available to any other person or entity without the written consent of Maxim Investment LLC.

By taking possession of and reviewing the information contained herein the recipient agrees to hold and treat all such information in the strictest confidence. The recipient further agrees that recipient will not photocopy or duplicate any part of the offering memorandum. If you have no interest in the subject property, please promptly return this offering memorandum to Maxim Investment LLC..

The information contained herein is not a substitute for a thorough due diligence investigation. Maxim Investment LLC. has not made any investigation, and makes no warranty or representation with respect to the income or expenses for the subject property, the future projected financial performance of the property, the size and square footage of the property and improvements, the presence of absence of contaminating substances, PCBs or asbestos, the compliance with local, state and federal regulations, the physical condition of the improvements thereon, or financial condition or business prospects of any tenant, or any tenant's plans or intentions to continue its occupancy of the subject property.

The information contained in this offering memorandum has been obtained from sources we believe reliable; however, Maxim Investment LLC. has not verified, and will not verify, any of the information contained herein, nor has Maxim Investment LLC. conducted any investigation regarding these matters and makes no warranty or representation whatsoever regarding the accuracy or completeness of the information provided. All potential buyers must take appropriate measures to verify all of the information set forth herein. Prospective buyers shall be responsible for their costs and expenses of investigating the subject property.

THE TEAM



Alan Steighner
Owner Investor
alan@nichx.com
P. 704-506-1376

Theresa Steighner
President Owner Investor
theresa@nichx.com
P. 704-562-8045



Maxim Investment LLC.

PO Box 1143
Davidson NC 28036